

# REDFIX U

## ACOUSTIC INSULATION FOR WALLS AND CEILINGS

### ANTI-VIBRATION CONNECTIONS FOR WALLS AND CEILING

#### ■ TECHNICAL SPECIFICATION

"U" shaped decoupling bracket for suspended ceilings on double crossed frames, with dimension 35 mm x 35 mm (base) and length ... mm, with an antivibration rubber support and washer.

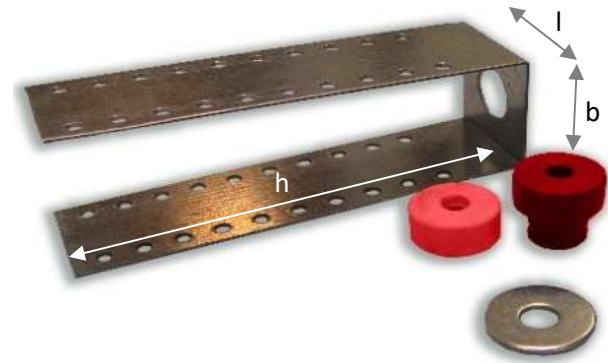

#### ■ INSTALLATION INSTRUCTIONS

Make the holes in the ceiling to set the position of Redfix U elements for the installation of the primary steel frame with a "U" profile, with a spacing of 50 cm (usually), and with hooks for the mechanical connection of the secondary frame. For the total number of hangers, consider a specific load of maximum 25 kg for each hanger. The connection should be made exclusively on the structural elements of the floor with homologated steel anchors as Fischer FNA II, FBN II, FBS for traditional floors or structural screws for wooden floors. Fasten the primary frame to the Redfix U hangers with wafer head drywall screws.

#### ■ TECHNICAL DATA

Base dimension (b x l)	35x35 mm
Thickness of antivibration support	10 mm
Hardness	45 Shore A
Density	1030 kg/m <sup>3</sup>

Length (h)	80-100-120 mm
Thickness	10/10
Washer - External diameter	24 mm
Washer - Hole diameter	8 mm

# REDFIX U

## ACOUSTIC INSULATION FOR WALLS AND CEILINGS

### SPECIFIC LAYING INSTRUCTIONS FOR REDFIX IN CEILING

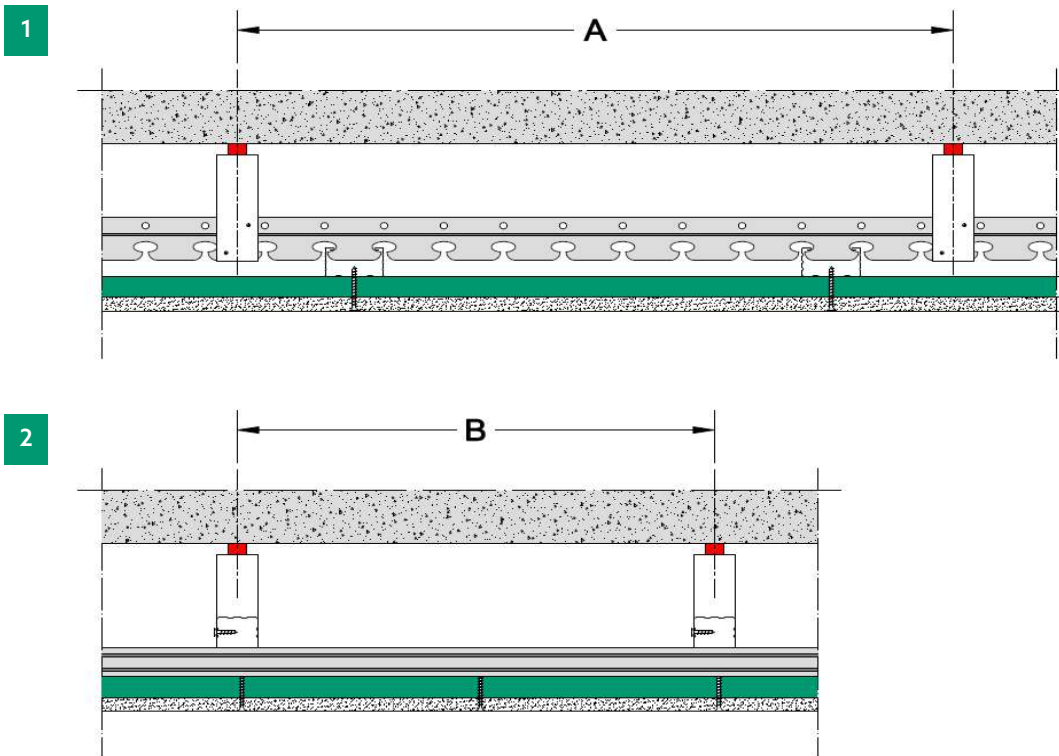

#### HANGERS DISTANCE - FRAME DISTANCE

Maximum load for Redfix: 25 kg

Load class	Redfix distance (A) - figure 1	Frame distance (B) - figure 2
up to 15 kg / m <sup>2</sup>	1000 mm	600 mm
up to 30 kg / m <sup>2</sup>	900 mm	500 mm



**ACOUSTIC CERTIFICATES**  
Product acoustic certificates are available and allow to comply with the limits imposed by law



**INSTALLATION TEST**  
Acoustic performances of the intervention can be tested on site by a competent technician



**ACOUSTIC REPORT**  
Our technical staff is able to give you the proper support in all the project phases, supporting you in the identification of materials



**LAYING ASSISTANCE**  
Thanks to our extensive commercial technicians network, we are at your disposal for the coordination of the first laying phases on site

[SEE THE REFERENCES > VISIT THE WEBSITE](#)

[CONTACT THE TECHNICAL DEPARTMENT FOR MORE INFORMATION](#)



www.isolgomma.com  
PRG-MOD. 15 - REV. 5.1 07/06/22 EN

© Isolgomma Srl. The data and images are indicative and can be changed at any time without notice



# REDFIX U

## ACOUSTIC INSULATION FOR WALLS AND CEILINGS

### STATIC AND DYNAMIC CHARACTERISTICS REDFIX U

#### ■ COMPRESSION BEHAVIOR

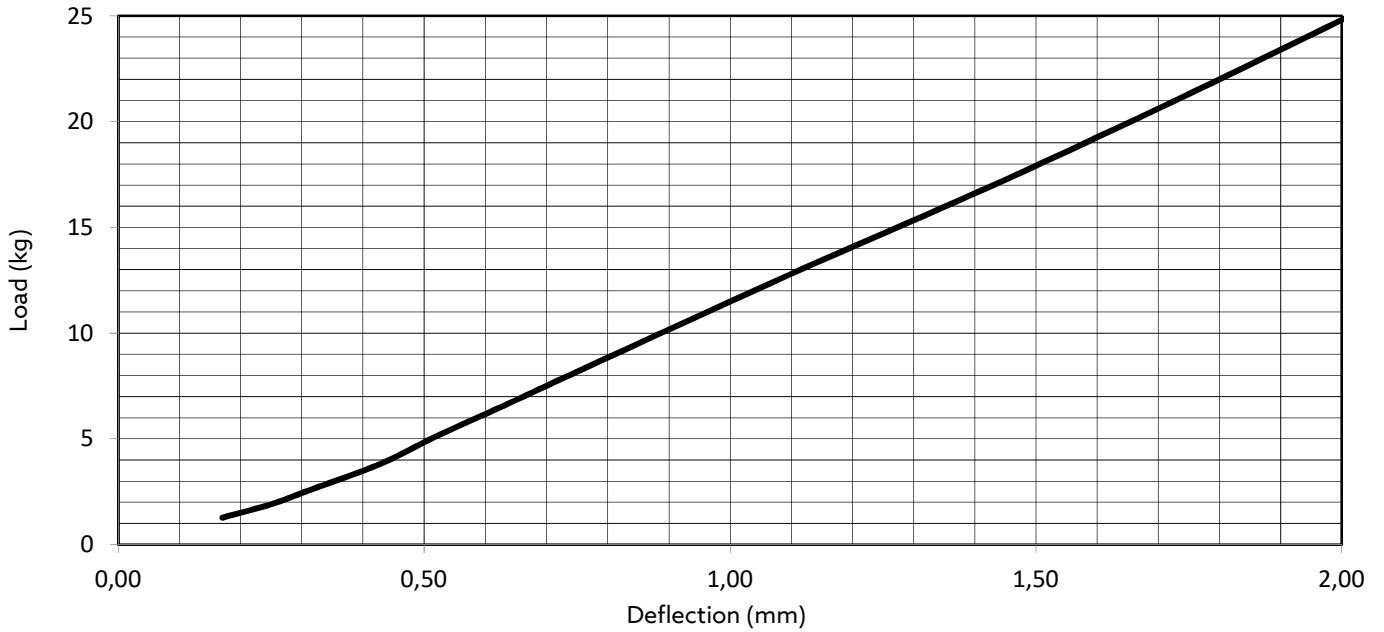

#### ■ NATURAL FREQUENCY

