

REDFIX L

ACOUSTIC INSULATION FOR WALLS AND CEILINGS

ANTI-VIBRATION CONNECTIONS FOR WALLS AND CEILING

■ TECHNICAL SPECIFICATION

"L" shaped bracket for decoupling metal studs in the gypsumboard wall linings, with dimension 50 mm x 50 mm (base) and length ... mm, equipped with an antivibration rubber support and washer.

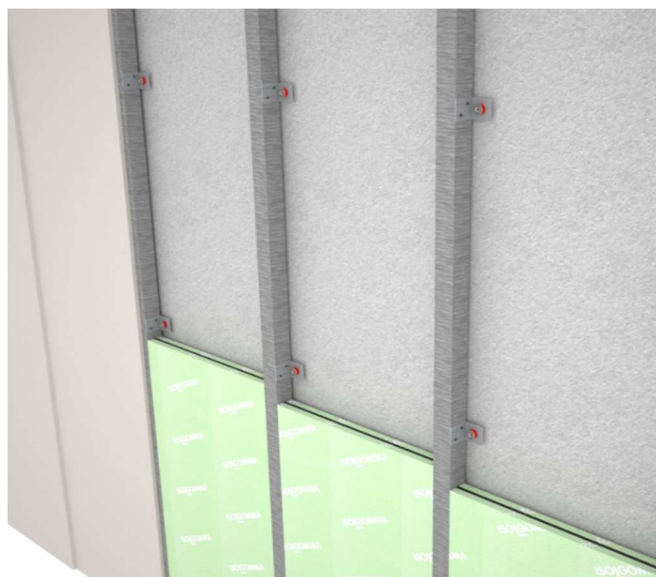
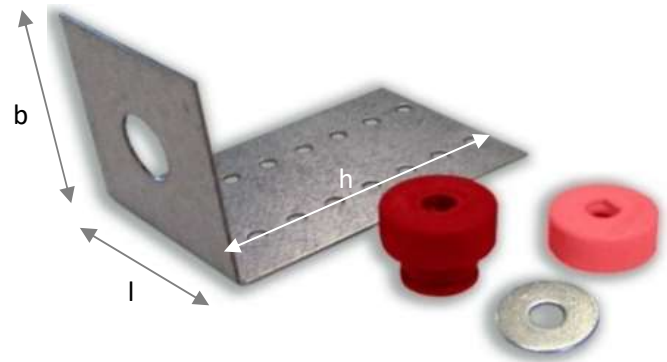

■ INSTALLATION INSTRUCTIONS

Install the steel structure at a distance of 1 cm from the base wall. Make holes in the chosen points for fastening; the hole should be positioned at 25 mm from the back of the vertical stud. Place Redfix L on the hole and fix it with a proper mechanical fastening; the anchor system should be chosen according to the typology of the base wall. Fasten Redfix L to the vertical steel stud with wafer head drywall screws .

■ TECHNICAL DATA

Base dimension (b x l)	50x50 mm
Thickness of antivibration support	10 mm
Hardness	45 Shore A
Density	1030 kg/m ³

Length (h)	50-60-80-100 mm
Thickness	10/10
Washer - External diameter	24 mm
Washer - Hole diameter	8 mm

REDFIX L

ACOUSTIC INSULATION FOR WALLS AND CEILINGS

STATIC AND DYNAMIC CHARACTERISTICS REDFIX L

■ COMPRESSION BEHAVIOR

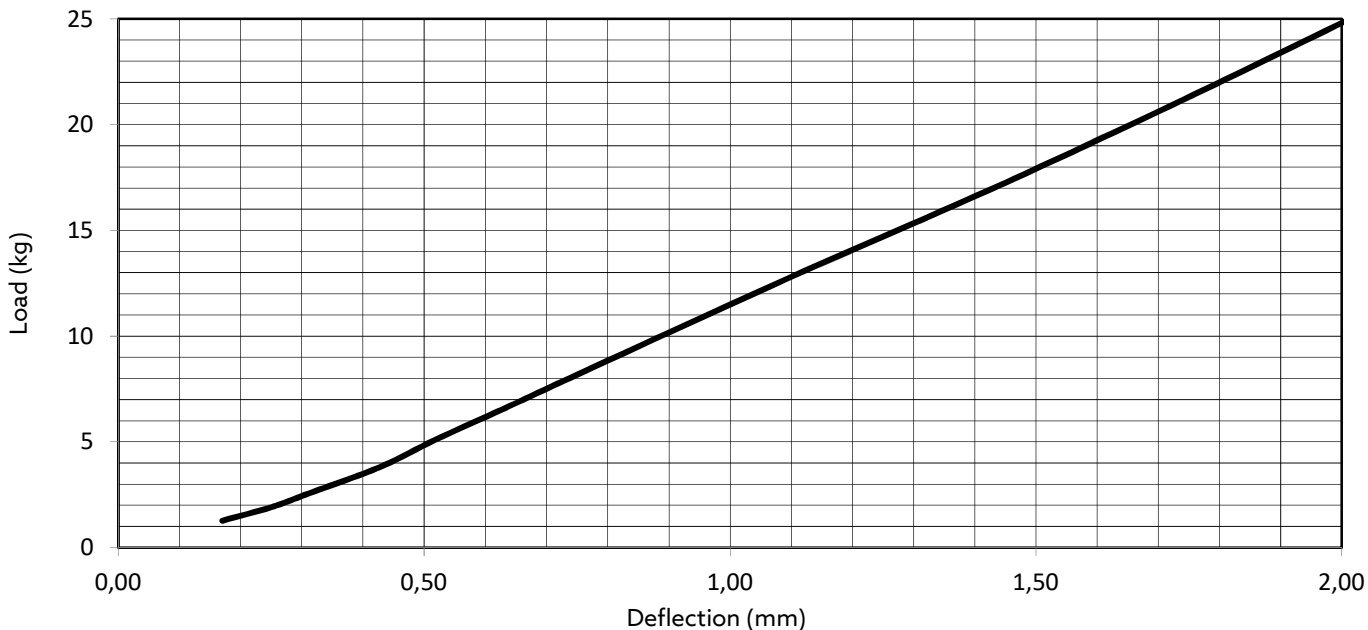

■ NATURAL FREQUENCY

