

# PROFYLE

## UNDER SCREED ACOUSTIC INSULATION



DECOUPLING ELEMENT MADE OF ADHESIVE AND SHAPED POLYETHYLENE



### ■ TECHNICAL SPECIFICATION

Edging stripes for floors screed made of polyethylene, grey colour, thickness ..... mm with adhesive on the two external sides. The dimensions are: base ..... cm, height ..... cm, density ..... kg/m<sup>3</sup>.

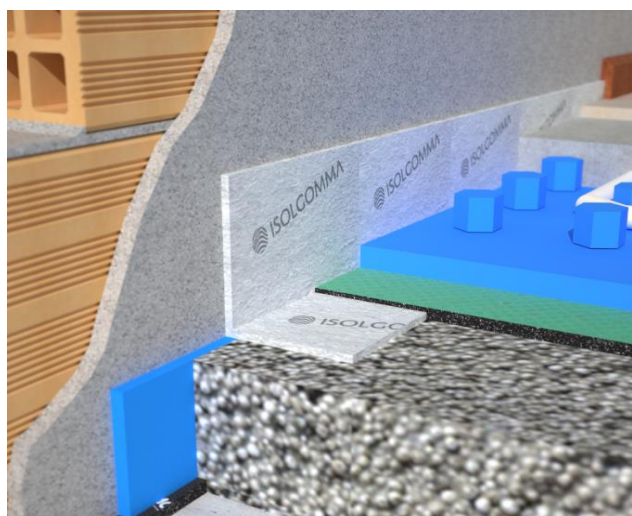

### ■ CERTIFIED ACOUSTIC IMPROVEMENT

Decoupling element essential to give insulation continuity and avoid acoustic bridges with walls

### ■ FLEXIBILITY

Made of partially adhesive polyethylene already shaped, it can be used both on residential and commercial solutions

### ■ LAYING COSTS REDUCTION

This "L" shaped accessory facilitates installation and ensures adequate insulation continuity between floor and wall

### ■ TO BE USED WITH

Mandatory with under screed impact sound solutions and useful for screed/wall decoupling

### ■ TECHNICAL DATA

Length (L)	1,50 m
Height (h)	150-200 mm
Width (b)	50-100 mm

Thickness	6 mm
Dynamic stiffness s <sup>i</sup>	36 MN/m <sup>3</sup>
Reaction to fire	F
Thermal conductivity coefficient λ	0,035 W/m K

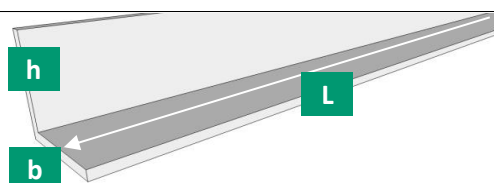

# PROFYLE

## UNDER SCREED ACOUSTIC INSULATION



### INSTALLATION INSTRUCTIONS FOR PROFYLE

**1** Clean the applying surfaces from dirty and sharp parts

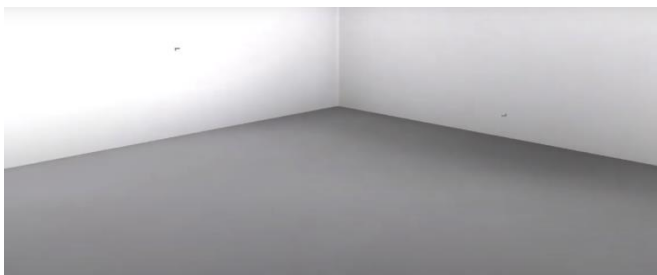

**2** Remove the protection film

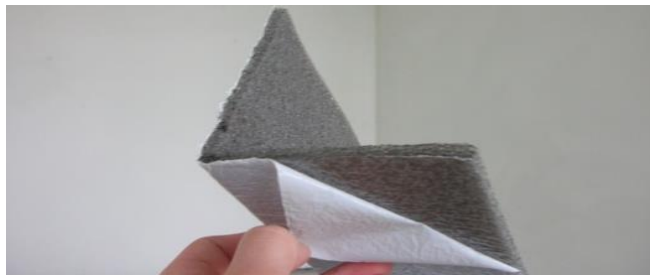

**3** Glue the strip on both floor and wall surfaces by the external profile strip surfaces

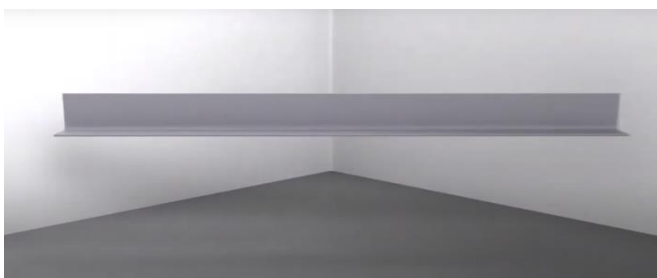

**4** Insulate the acute corners with the Profile strip by cutting it as shown in the drawing



**5** Insulate the obtuse corners with the Profile strip by cutting it as shown in the drawing

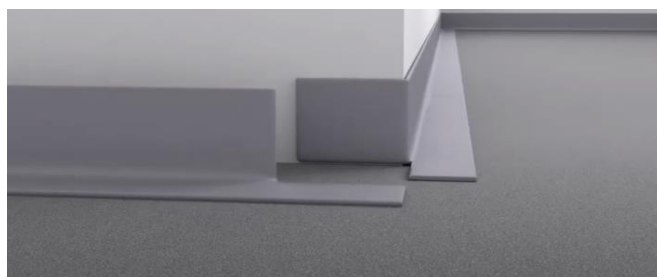

**6** Apply the Profyle all along the walls room perimeter, as shown in the drawing

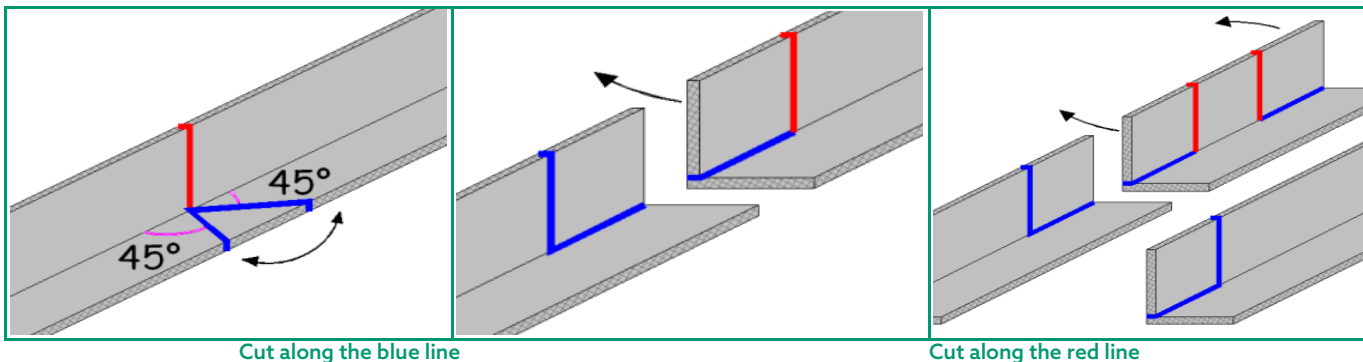
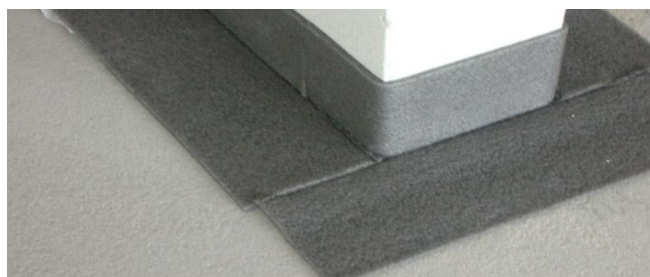

Cut along the blue line

Cut along the red line